



Guangzhou Micro-shot Technology Co., Ltd

Inverted LED Fluorescence Attachment

**MI-BGU-LED
IX50/IX70
User Manual**

Email: sales@mshot.com

Thank you for buying our product!

This unit is a precision optical instrument. Our product has been design to provide the highest level of safety, however, improper operation or negligence in following the instructions in this manual may cause personal injuries and property losses. In order to ensure your safety, prolong the life of this unit and maintain it properly, please read this manual carefully before operating this unit.

Warning

- Do not use or place the instrument in the place with high temperature, humidity or dust for a long time
- Suitable working temperature: 5 °C to 35 °C
- Suitable relative humidity 20% to 80% (25 °C)

Note: do not immerse the instrument in water or solvent

Note: do not place accessories not provided by our company in the frame body or other transmission parts

Maintenance and storage

1. Wipe and clean all glass components with gauze. In order to remove fingerprints or other oil stains, use a very small amount of 2 parts of ether + 1 part of ethanol mixture solution as cleaning agent, wet the gauze and wipe it gently.

 Ether and ethanol are extremely flammable and must be handled with care. Be careful not to put these chemicals near open flames and possible sources of spark, such as switches. Be sure to use it in a well ventilated room.

2. For the non optical parts of the device, do not use organic solvent to wipe, but clean cloth can be used. If it is very dirty, please use a soft cloth with a small amount of neutral detergent to wipe.

3. Do not disassemble any part of the device arbitrarily, or it may cause failure or reduce performance.

Content

I. Main parts.....	01
II. Specification.....	02
III. Components.....	03
IV. Installation.....	04~05
V. Note.....	05

I. Main parts

No.	Name	Quantity	Unit
1	Attachment body	1	set
2	Power adapter	1	piece
3	Light barrier	1	piece



II. Specification

B excitation group	EX480/40nm DM505nmLP EM510nmLP
G excitation group	EX530/40nm DM570nmLP EM590nmLP
UV excitation group	EX360/50nm, DM400nmLP EM420nmLP
Light source	3W LED cold light
Observation	Fluorescence, bright field
Transfer mode	Pull-push at three positions (Blue, green, bright field)
Brightness adjustment	Continuous adjustment
Input power	DC12V 2A
Matched microscope	Olympus IX50, IX70

III. Components

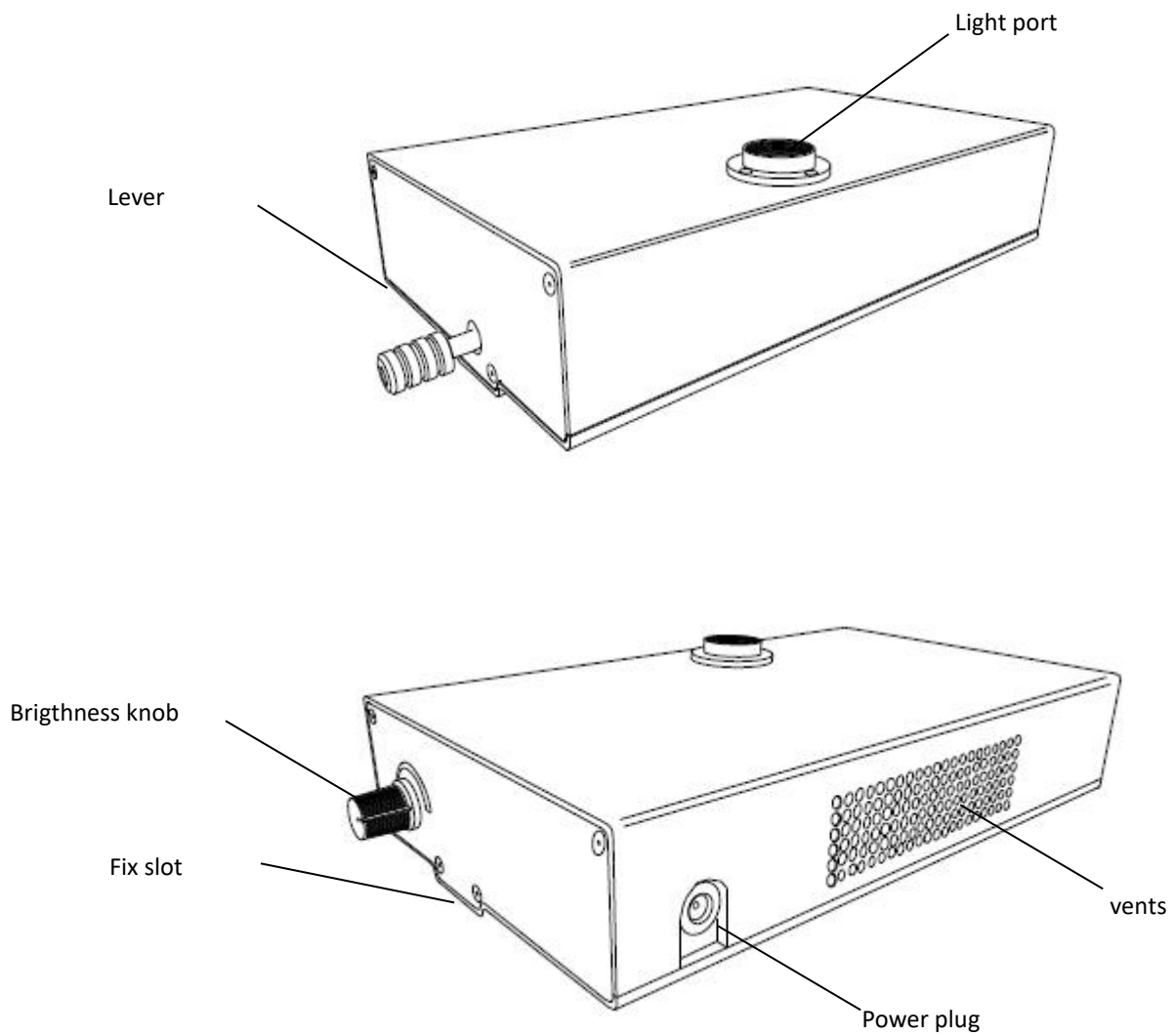

Instructions:

Light port - Let fluorescence illuminating light pass

Power plug - Connect AC adapter to supply power

Brightness knob- Used to adjust fluorescence lighting brightness

Lever- Move BGU filter groups and lamps

Vents- Heat transmission

Fix slot - Screw to fix the attachment body

IV. Installation

1. Unpack MI-BGU-LED illuminator and power adapter.
2. If the microscope already has attachment under the condenser, please take it off. Find the plastic box on right hand of the microscope as image 01 and take off it slightly.



Image 01

3. Insert in the illuminator from the right side of the microscope bottom body as image 02 and image 03, notice to match slider rail on the illuminator bottom with the microscope rail.



Image 02

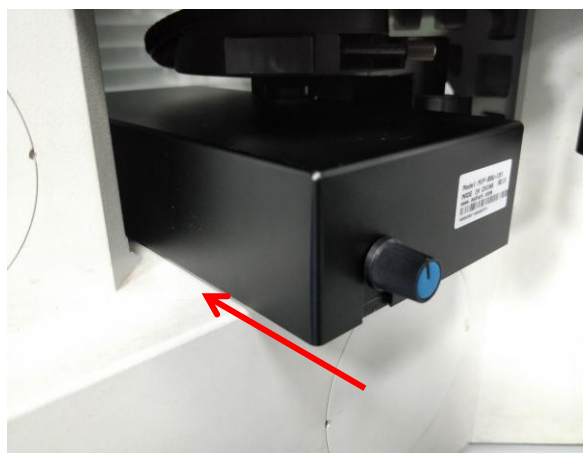

Image 03

4. Lock the screw on the right side of the main body of the microscope (fix slot) with a hexagonal screwdriver as image 04.

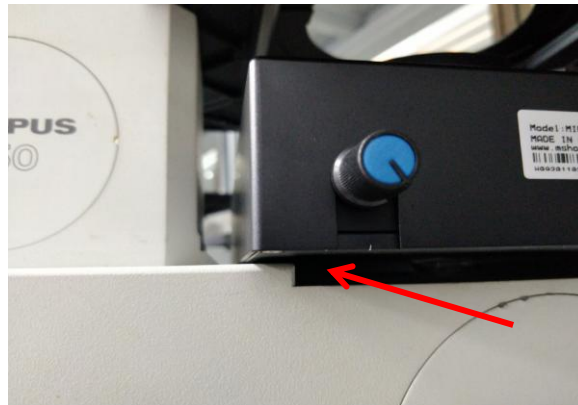

Image 04

5. Connect the power adapter to the illuminator and power on to start use. Push or pull lever to change fluorescence filter cube among blue, green, UV and bright field



Image 05

V. Note

1. Push or pull lever to change fluorescence filter cube among blue, green, UV and bright field. The "O" channel should be used in bright field.
2. If no light is emitted from the illuminator, check that the power adapter is properly connected.
3. If the illuminator shakes, check the locking screw on the right side of the microscope body and lock it with a hexagonal screwdriver.